

Arkroof - twin skin – acoustic roof: 53-a-Ark-Sys-03/2015

p 1 of 3

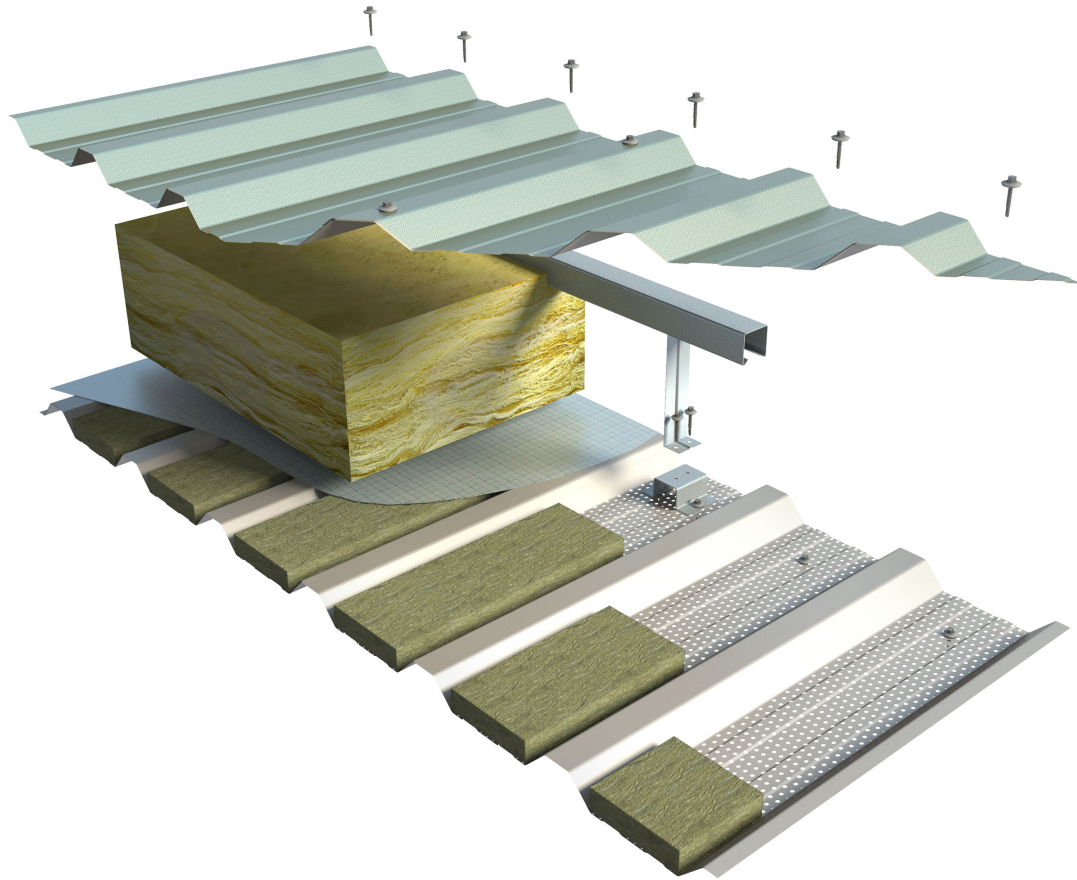

Arkroof - system construction

Outer profile	Arkroof 32.1000.200-0.7mm-Roof. Refer to Ark product data sheet 01-Ark-Prod
Insulation	Glass or rock mineral wool quilt to BS EN 13162 and BS3533:1981, non-combustible Euroclass A1 to BS EN ISO 13501-1 Thickness as System Performance table below.
Spacer	Bracket and rail spacer system. 1.5mm galvanised steel brackets to depth as System Performance table below, max spacing 1m. 1.25mm galvanised steel rail, interlocking end joints, bracket stability braces at 20m max spacing on brackets of 250mm and above. Fix to 2mm galv steel 20/30/40/30/20mm x 60mm tophat stools located under the vcl. All fasteners to be 5.5mm dia plus 16mm dia sealer washers
VCL and air barrier	250gsm reinforced polyethylene membrane. Laps sealed using 1.5mm x 20mm butyl sealant, 2No strips. VCL robustly sealed to perimeters and penetrations. Use solid profiled filler blocks bedded in gun applied sealant under and over liner at eaves/ ridge. Bed VCL and clamp to fillers using an angle strip. Lay vcl parallel to liner for lap support. Seal side laps over rib for support. Alternative self adhesive 0.6mm foil faced vcl, prime ribs.
Acoustic insulation	30mm x 115mm black or white tissue faced 45kg/m ³ rock fibre strips
Liner	Arkliner 32.1000.200-0.65mm perfo. Pan perforated 45% open area. Refer to Ark product data sheet 30-Ark-Prod-Arkliner

Arkroof - twin skin – acoustic roof: 53-a-Ark-Sys-03/2015

p 2 of 3

Arkroof - system performance data

U value	W/m ² K	0.25	0.24	0.23	0.22	0.21	0.20	0.19	
Spacer depth/ compressed insulation depth	mm	180	190	200	210	220	230	240	
Insulation roll size	mm	200	210	220	240	250	260	270	
Insulation lambda value	W/mK	0.040	0.040	0.040	0.040	0.040	0.040	0.040	
Depth of roof	mm	212	222	232	242	252	262	272	
Weight of roof	kg/m ²	16.9	17.0	17.1	17.4	17.5	17.6	17.7	
Bracket stability brace required?		No	No	No	No	No	No	No	
U value	W/m ² K	0.18	0.17	0.16	0.15	0.14	0.13	0.12	0.11
Spacer depth/ compressed insulation depth	mm	250	270	280	300	300	350	300	350
Insulation roll size	mm	280	300	310	330	330	390	330	390
Insulation lambda value	W/mK	0.040	0.040	0.040	0.040	0.037	0.037	0.032	0.032
Depth of roof	mm	282	302	312	332	332	382	332	382
Weight of roof	kg/m ²	17.9	18.1	18.2	18.5	19.8	20.7	25.1	27.0
Bracket stability brace required?		Yes	Yes	Yes	Yes	Yes	No (refer Ark)	Yes	No (refer Ark)

Arkroof - system data

Non-fragility	Non Fragile Class B to ACR[M]001. Refer to Ark product data sheet 02-Ark-Prod Arkliner
Fire properties	Insulation is EuroClass A1 to BS EN ISO 13501-1, non combustible Liner Class 0, Topsheet Class AA to National Standards (Refer to Ark product data sheets 01-Ark-Prod Arkroof and 02-Ark-Prod Arkliner)
Minimum pitch	Nominal 4°, on a curved roof end lap pitch must be 4° or greater.
Guarantees and Warranties	Ark Silver and Ark Gold. Refer to Ark technical data sheet 05-Ark-Tech “Warranties and guarantees”
Curve options	Natural curve to 40m minimum radius. Crimp curve to 1m minimum radius
Fasteners, sealants	Refer to Ark product data sheets 30-Ark-Prod-Arkliner perfo and 02-Ark-Prod Arkroof
Airtightness	Arkroof systems with a sealed vcl are inherently airtight and contribute to low building air leakage rates. The vcl is the air barrier and vapour control layer and has sealed side and end laps and robust sealing at eaves, ridge and verge. Penetrations (SVP etc) must be sealed into the vcl as well as into the outer sheet. The most robust vcl is a self adhesive membrane with self sealing laps and the ability to bond to perimeters and penetrations. These tend to be the most resistant to damage and better in the long term.

Arkroof - twin skin – acoustic roof: 53-a-Ark-Sys-03/2015

p 3 of 3

<p>Installation key requirements</p>	<p>Insulation must be dry when covered by the outer sheet. Insulation must fill the insulation cavity with minimal gaps around the spacer Fasteners for liner and spacer brackets are carbon steel self drillers and must have 15/16mm diameter sealed washers Liner fixings are in every trough at end laps, ridges and eaves, alternate troughs at intermediate purlins. Fasteners for outer sheets are 304 grade stainless steel with coloured heads and 19mm diameter sealer washers. Spacer brackets must have 2 fasteners per bracket. Spacer brackets max 300mm from joggle joint Isolate aluminium from galvanised steel Liners must be sealed all round, including fillers bedded in sealant</p>
<p>Rooflights</p>	<p>In-plane 32/1000 profiled site assembled triple skin GRP rooflight. 2.4kg/m² inner and outer GRP, 4 wall polycarbonate internal layer, Class B non-fragility, U=1.3W/m²K Partner company Brett Martin Daylight Systems, www.daylightsystems.com</p>
<p>Insulation</p>	<p>Earthwool Ecosse FactoryClad 40/37/32 glass mineral wool quilt to BS EN 13162BS and BS3533:1981, non-combustible Euroclass A1 to BS EN ISO 13501-1 Partner company Knauf Insulation Ltd, www.knaufinsulation.co.uk Acoustic batts, RW3 White or black T/F Partner company Rockwool Ltd www.rockwool.co.uk</p>
<p>Roof safety systems</p>	<p>Partner company Latchways plc, www.latchways.com Partner company QBM Distributors Ltd, www.qbmdistributors.co.uk</p>
<p>Fasteners</p>	<p>Partner company EJOT UK Ltd, www.ejot.co.uk Partner company SFS intec Ltd, www.sfsintec.biz/uk Partner company Woodall Fastening Systems Ltd, www.techscrew.com Partner company QBM Distributors Ltd, www.qbmdistributors.co.uk</p>